

2016.1

# MOTOSPORTS QUALITY ROD ENDS SPHERICAL BEARINGS and accessories



TATUUS F4

## AURORA®



DISTRIBUIDOR EN EXCLUSIVA

RODAMIENTOS, TRANSMISIÓN Y SISTEMAS DE ENGRASE

P.E. Granland - C/ Francesc Teixidó, 10  
08918 BADALONA (Barcelona) SPAIN  
T. +34 93 459 06 18 FAX +34 93 457 91 99  
collvilaro@collvilaro.com - www.collvilaro.com



KISS 209M - FAMA' HELICOPTERS



ORAM for TATUUS



ACERNI



MYGALE F4



NUON solar car - TU Delft



PEUGEOT rallycross



DUCATI racing team



F Student  
TU Graz



UNIBO Motorsport





**TOP QUALITY  
ROD ENDS and  
SPERICAL BEARINGS  
for MOTORSPORTS**



**narrow series**  
schmale Reihe  
série étroite  
serie stretta



**wide series**  
breite Reihe  
série epaisse  
serie larga



**with staking groove**  
mit Vestemmungsnut  
à sertir  
da cianfrinare



**high misalignment**  
hoher Kippwinkel  
grand misalignement  
alto angolo di ribaltamento



Since 1971, the **Aurora Bearing Company**, with facility in Montgomery, Illinois (USA), has been exclusively designing and manufacturing rod ends and spherical bearings with sliding couplings

This company is since then well established on various markets, earning a world-wide reputation, supplying parts for *general industrial* needs as well as for those very demanding applications typical for the *military*, *aerospace* and *motor sports* branches.



## MOST FREQUENTLY USED ITEMS IN MOTORSPORTS APPLICATIONS



shaft thread  $\varnothing$  = ball bore  $\varnothing$

### AM-..T

#### high strength alloy

alloy steel ball  
alloy steel race  
alloy steel body,  
zinc plated

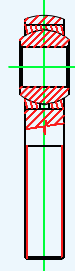
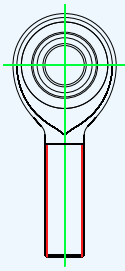

### XAM-..T

#### high strength alloy heavy duty shanks

alloy steel ball  
alloy steel race  
alloy steel body,  
zinc plated

shaft thread  $\varnothing$  > ball bore  $\varnothing$

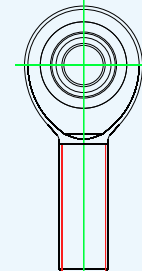

### RAM-..T

#### high performance

alloy steel ball  
alloy steel race  
alloy steel body,  
bright nickel plated

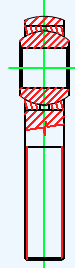
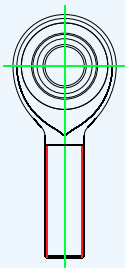

### RXAM-..T

#### high performance heavy duty shanks

alloy steel ball  
alloy steel race  
alloy steel body,  
bright nickel plated

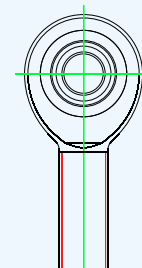

### PRM-..T

#### performance racing

alloy steel ball  
stainless steel race  
alloy steel body  
aerospace quality PTFE

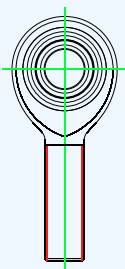

### PRXM-..T

#### performance racing heavy duty shanks

alloy steel ball  
stainless steel race  
alloy steel body  
aerospace quality PTFE

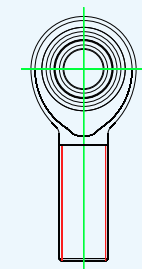

aerospace experience for best motorsports performance  
Erfahrung aus der Luftfahrt für höchste Motorsportleistung  
expérience aéronautique pour résultats compétition  
esperienza aerospaziale per massima prestazione motorsport

### HXAM-..T

#### high misalignment

alloy steel ball  
alloy steel race  
alloy steel body  
aerospace quality PTFE

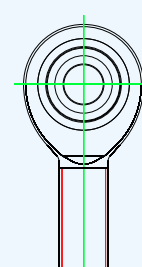

## NARROW SERIES

**COM-..T** generic application

**COM-T-KH** impact and wear resistant

**PNB-..T** performance racing

**PNB-TG** performance racing, grooved

**ANC-..T** aerospace qualified

**ANC..TG** aerospace qualified, grooved

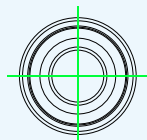

grooved

## WIDE SERIES

**PWB-..T** performance racing

**PWB-TG** performance racing, grooved

**AWC-..T** aerospace qualified

**AWC..TG** aerospace qualified, grooved

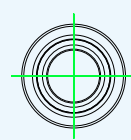

grooved

## HIGH MISALIGNMENT

**HAB-..T**

**HAB-..TG** grooved

**HAB-M..TG** metric sizes, grooved

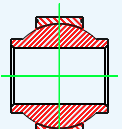
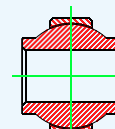
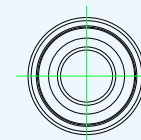

grooved

...many other types and sizes available

